

KWIK HUS	h_1^*	t_{fix}
$5/8 \times 4$	$4\ 3/8 - t_{fix}$	$0 \dots 3/4$
$5/8 \times 5\ 1/2$	$5\ 7/8 - t_{fix}$	$0 \dots 1/2$
$5/8 \times 6\ 1/2$	$6\ 7/8 - t_{fix}$	$0 \dots 1\ 1/2$

	SIW 22T/18T-A	<input checked="" type="checkbox"/>	<input checked="" type="checkbox"/>
	SIW 9-A22	<input checked="" type="checkbox"/>	<input type="checkbox"/>
		85 ft-lb	

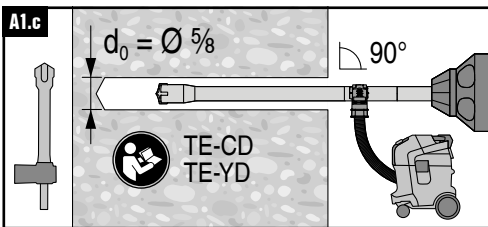

*For non-hole cleaning installation (steps A1.a or A1.b), make sure to drill deep enough to achieve h_1 , taking into account the depth of debris remaining in the hole

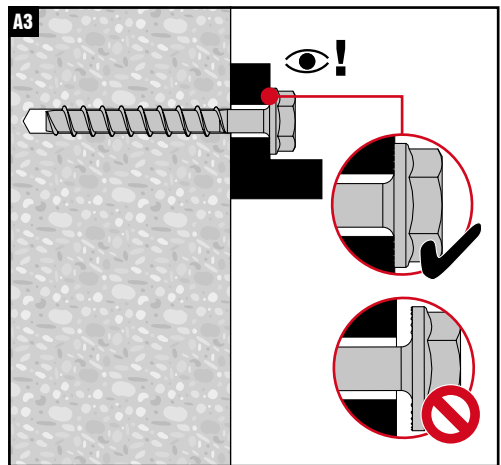
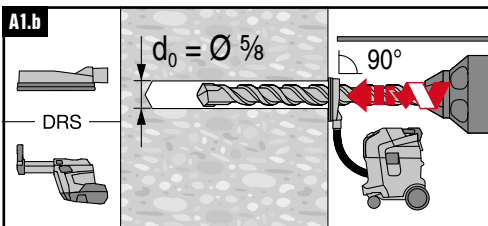
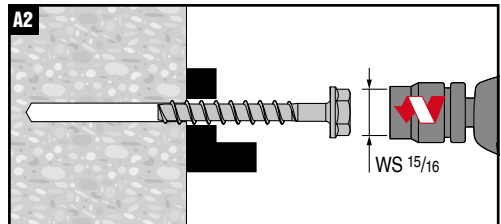
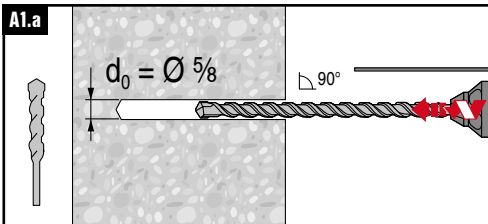
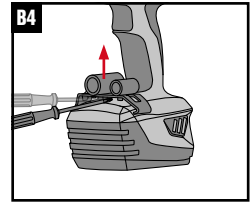
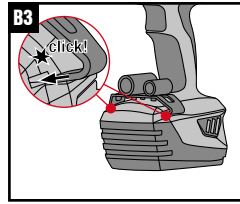
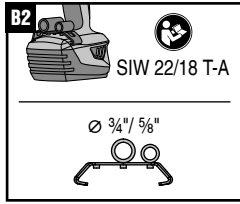
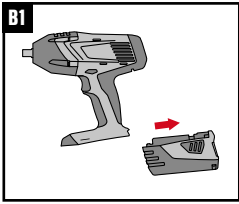
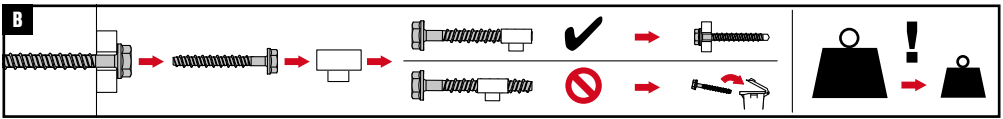

< 3000 psi	5/8 x 4	5/8 x 5...7
SIW 22/18-A	✓	✓
SIW 22T/18T-A	✗	✓
	85 ft-lb	

≥ 3000 psi	5/8 x 4	5/8 x 5...7
SIW 22/18-A	✓	✓
SIW 22T/18T-A	✗	✓
	85 ft-lb	

